

CUSTOMER COPY

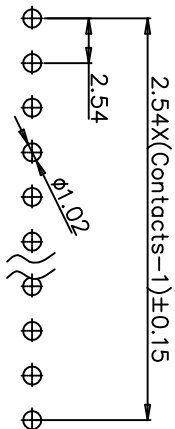

REVISION DATA				
SYM	ECN	DESCRIPTION	DATE	APPROVED

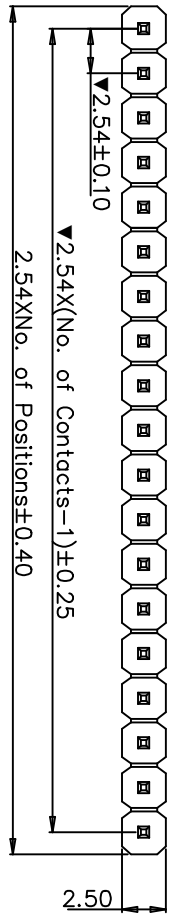

Recommended P.C.B Layout(±0.05)

Technical Data
 Contact: brass JIS C2700(Cuzn35)
 Contact plating: see ordering information
 Insulator: black glass filled polyester UL94V-0
 Current rating: 3Amps
 Contact resistance: 20mΩ max.
 Insulation resistance: 1000MΩ min. at 100V
 Withstanding Voltage: 550V AC/minute
 Retention force: 1Kg/contact min.
 Operating temperature: -55°C to +105°C
 Soldering temperature: 245°C±5° 5S
 Critical Dimensions:▼

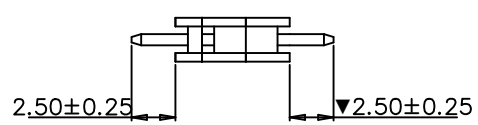
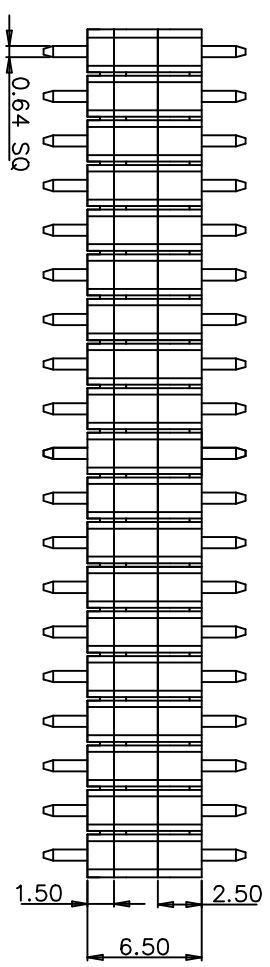

Ordering information

QHA1 25 3 - P XX X X A 15

High Option
25: H=2.54mm

No. of Positions
01-40

Plating Option
A: G/F
B: Au3u"
C: Au5u"
D: Au10u"
H: G/F/Sr/20u"
S: Sr/20u"
Z: Special (Underline option is standard)

Insulator Material Option
A: BK-PBT
F: BK-LCP
G: BK-PA9T
S: Special (Underline option is standard)

Type Option
A: Normal
C: With CAP

Serial No
01-99

Packing	TOLERANCE:
1. General	ANGLE ±2°
2. Tape&Reel	X.XXX ±0.01
3. Tube	X.XX ±0.25
4. Tray	X.X ±0.35
5. Other	X. ±0.50

natconn 广东纳特康电子股份有限公司
 GUANGDONG NATCONN ELECTRONIC CO.,LTD

PROJECTION	TITLE:	CUSTOMER:	CUSTOMER P/N:	REV:
DATE: 2013/05/27	2.54mm Pin Header Single Row Straight W=2.5mm	N/A	N/A	N/A
DRAWN: 徐晓媚		PART NO.:	DRAWING NO.:	REV:
CHECKED: 唐建平		QHA1253PA15	QHA1253PA15	A
APPROVED: 冯显东		SIZE: A4	SCALE: 1:1	SHEET: 1/1