

CUSTOMER COPY

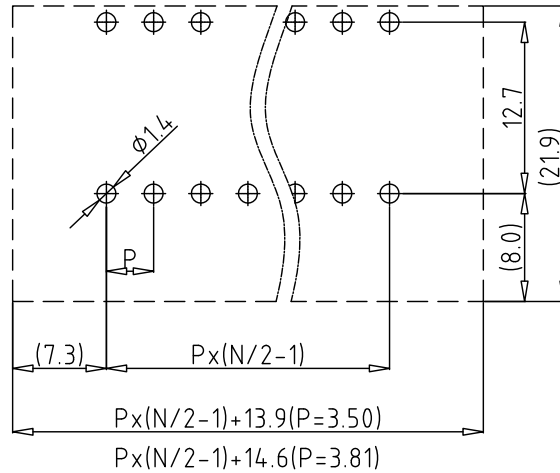

REVISION DATA				
SYM	ECN	DESCRIPTION	DATE	APPROVED

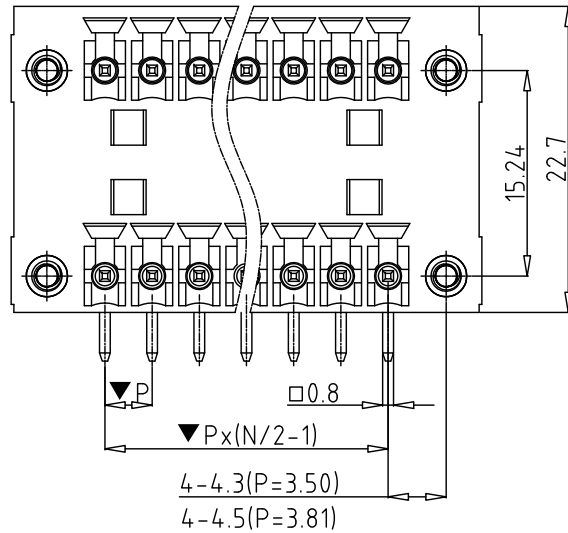

Recommended P.C.B Layout

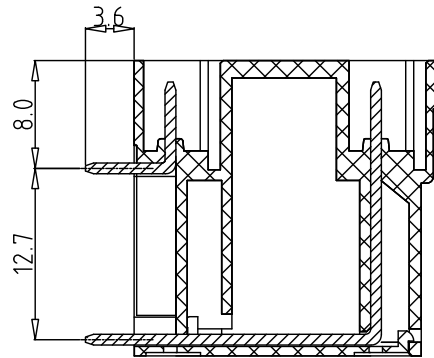
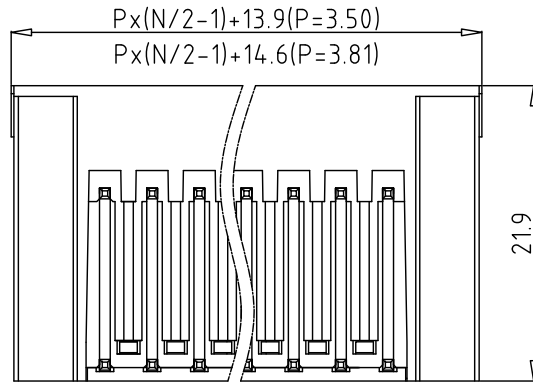

Technical Data

- Material:
 - Insulator: NY66, UL94V-0 RoHS
 - Solder pin: brass, tin plated
- Electrical:
 - Current rating: 10A
 - Voltage rating: 300V
 - Contact resistance: $\leq 20m\Omega$
 - Insulation resistance: $\geq 5000M\Omega$
 - Withstanding Voltage: 1600V AC/minute
- Mechanical:
 - Operating temperature: $-40^{\circ}C$ to $+105^{\circ}C$
 - Soldering temperature: $245^{\circ}C \pm 10^{\circ}C / 5S$
- Critical Dimensions: ▼

Ordering information

PPB	XX	X	2	X	0	X	00
Number of contacts		Pitch	Body type	Color	P.C.B mounting	Mark	Serial No.
04(2x2)~48(2x24) (Solid block)	4 3.5/.138" 5 3.81/.15"	2 With flange	0 Black 3 Orange 5 Green 6 Blue 8 Grey (Underline is standard)	0 Right angle	0 No mark 1 natconn 2 Customer 3 Others	00 Standard 01~99 Any special item by customer request	

natconn ® 广东纳特康电子股份有限公司		GUANGDONG NATCONN ELECTRONIC CO.,LTD	
TOLERANCE:	PROJECTION	TITLE: PPB Terminal Block,R/A Type	
ANGLE $\pm 2^{\circ}$	DATE	2015-7-30	
X.XXX ± 0.01	DRAWN	曹勇军	CUSTOMER: N/A
X.XX ± 0.25	CHECKED	唐建平	CUSTOMER P/N: N/A
X.X ± 0.35	APPROVED	冯显东	CUSTOMER P/N: N/A
X. ± 0.50			CUSTOMER P/N: N/A
		SIZE: A4	UNIT: mm
		SCALE: 1:1	SHEET: 1/1