

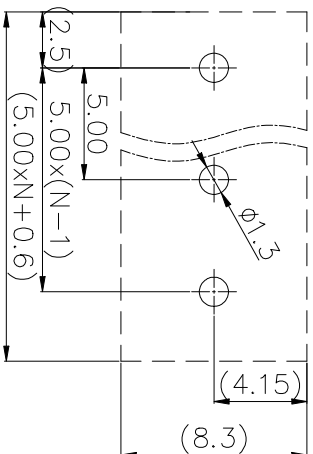

REVISION DATA				
SYM	ECN	DESCRIPTION	DATE	APPROVED

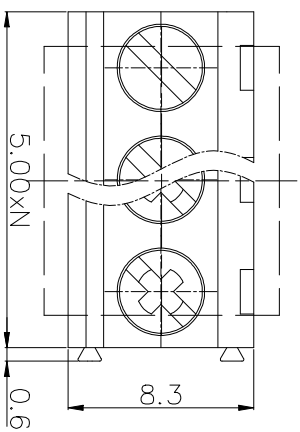

Recommended P.C.B Layout

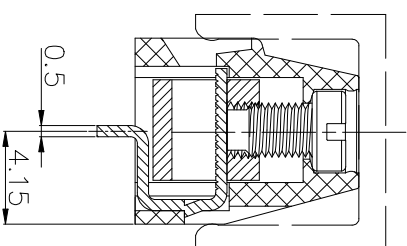
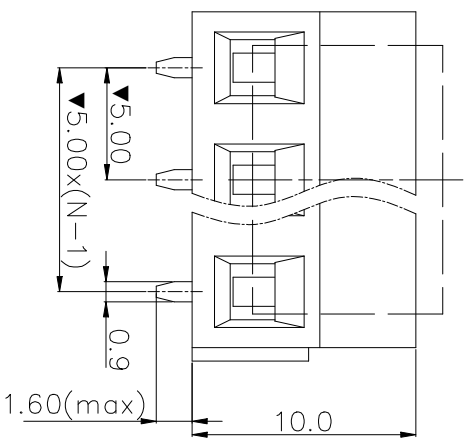

- Technical Data
- Material:
 - Insulator: PA9T, UL94V-0 RoHS
 - Screw: steel M3, galvanized plated
 - Cage clamp: brass (CuZn), nickel plated
 - Terminal: brass (CuZn), tin plated
 - Electrical:
 - Current rating: 10A
 - Voltage rating: 300V
 - Contact resistance: $\leq 20m\Omega$
 - Insulation resistance: $\geq 5000M\Omega$
 - Withstanding Voltage: 1600V AC/minute
 - Mechanical:
 - Wire range: 26~16AWG
 - Screw torque: 3.5lb-in
 - Wire strip length: 5-6mm
 - Operating temperature: -40°C to +105°C
 - Soldering temperature: 245°C \pm 10°C/5S
 - Critical Dimensions:
 - 4. Critical Dimensions: \blacktriangledown
 - 5. Compatibility with PININPASTE process.

Ordering information

RFA XX 6 X 0 1 X 02

Number of contacts Pitch Screw & Clamp Color Mark Serial No.

02~24 (pitch 3.5/3.81)
02~24 (pitch 5.0)
02~12 (pitch 1.0/0.2) (02&03 contacts stockable)

6 5.00/.197"
H 10.0/.394"

0 "-/+ " Combination type w/ brass machined clamp
1 "- " Slot type w/ brass machined clamp

0 Block

0 No mark
1 not conn
2 Custom
3 Others

00 Standard
01~99 Any special item by customer request

natconn®

广东纳特康电子股份有限公司
GUANGDONG NATCONN ELECTRONIC CO.,LTD

TOLERANCE: ANGLE $\pm 2^\circ$ X.XXX ± 0.05 X.XX ± 0.20 X.X ± 0.30 X. ± 0.50	PROJECTION: DATE 2019/12/10	TITLE: RFA(5.00) Terminal Block	CUSTOMER: N/A	CUSTOMER P/N: N/A	REV: N/A
	DRAWN: 林英明		PART NO.:	DRAWING NO.: RFAXX6X01X02	REV: A
	CHECKED:		SIZE: A4	UNIT: mm	SCALE: 1:1
	APPROVED:			SHEET: 1/1	