

CUSTOMER COPY

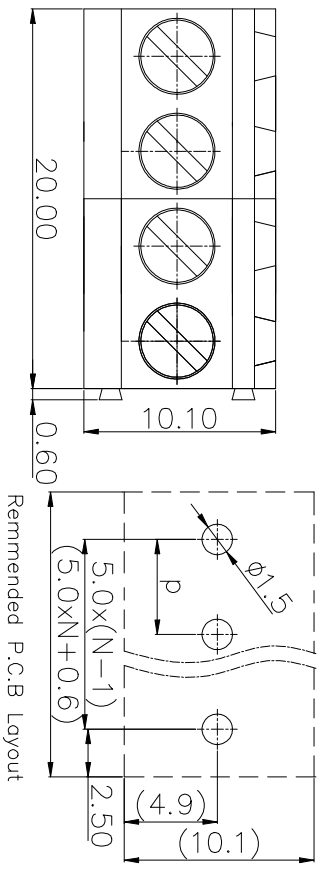

REVISION DATA				
SYM	ECN	DESCRIPTION	DATE	APPROVED



Recommended P.C.B Layout

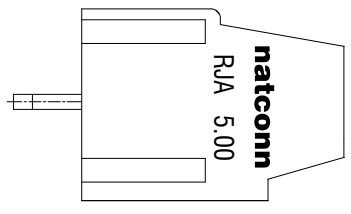
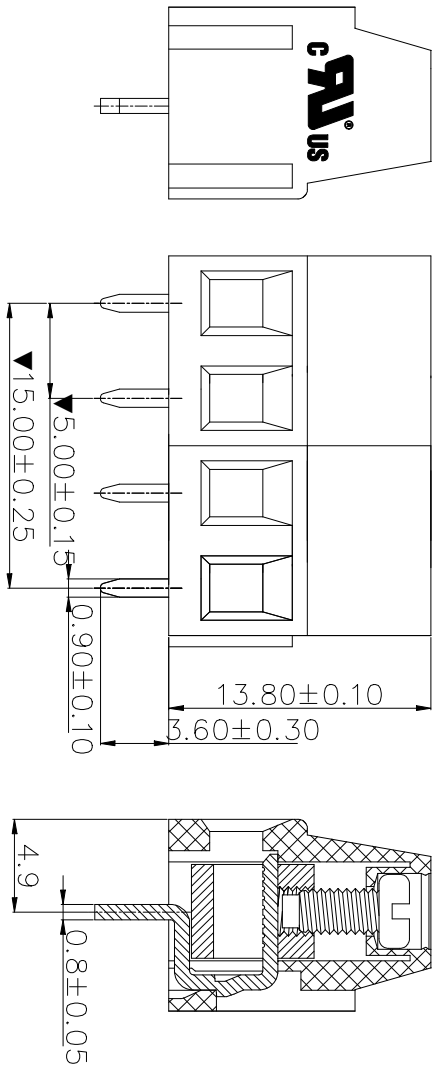

- Technical Data
- Material:
 - Insulator: NY66, UL94V-0 RoHS
 - Screw: steel M2.5, galvanized plated
 - Cage clamp: brass (CuZn), nickel plated
 - Terminal: brass (CuZn), tin plated
 - Electrical:
 - Current rating: 16A (test data)
 - Voltage rating: 300V
 - Contact resistance: $\leq 20m\Omega$
 - Insulation resistance: $\geq 50000M\Omega$
 - Withstanding Voltage: 2000V AC/1Min
 - Mechanical:
 - Wire range: 24~12AWG
 - Screw torque: 3.5Lb-in
 - Wire strip length: 6-7mm
 - Operating temperature: -40°C to +105°C
 - Soldering temperature: 245°C \pm 10°C/5S
 - Safety approval: **cRLus**, file No.: E355923
 - Critical Dimensions: ▼

Approval	cRLus
Current rating	10A
Voltage rating	300V
Wire range	24~12AWG
Screw torque	M2.5, 3.5 Lb-in

Ordering information

RJA	04	6	1	5	2 (EFL)	1	03
Number of contacts		Pitch		Screw & Clamp		Color	
02~24pitch5.0		6 5.00		1 "1"-Slot type w/ brass machined clamp		5 Green (绿色)	
						1 natconn	
						序列号	

natconn®

广东纳特康电子股份有限公司
GUANGDONG NATCONN ELECTRONIC CO.,LTD

TOLERANCE:	PROJECTION	TITLE:	CUSTOMER P/N:	REV:
ANGLE $\pm 2^\circ$		RJA Terminal Block (拼接反向)	N/A	N/A
X.XXX ± 0.01	DATE	201/11/21	CUSTOMER P/N:	N/A
X.XX ± 0.25	DRAWN	莫健勇	PART NO.:	RJA04XX52X03
X.X ± 0.35	CHECKED		SCALE:	1:1
X. ± 0.50	APPROVED		SIZE:	A4
			UNIT:	mm
			SCALE:	1:1
			SHEET:	1/1